

- LEGEND**
- BACKFLOW PREVENTER
 - BOLLARD
 - ⊕ ELECTRIC VAULT
 - ELEVATION
 - ⊕ FIRE HYDRANT
 - ⊕ GRATE INLET
 - ⊕ GREASE TRAP
 - ⊕ LIGHT POLE
 - ⊕ MITERED END SECTION
 - ⊕ POWER POLE
 - ⊕ SANITARY SEWER MANHOLE
 - ⊕ SEWER CLEAN OUT
 - ⊕ SIGN
 - ⊕ TELEPHONE PEDESTAL
 - ⊕ WATER METER
 - ⊕ WATER VALVE
 - ⊕ WELL
 - ⊕ GUY WIRE
 - U.G. SANITARY SEWER LINE
 - U.G. STORM SEWER LINE
 - ⊕ CAMPHOR
 - ⊕ DAK
 - ⊕ PALM
 - ⊕ PINE
 - ⊕ CEDAR
 - ⊕ UNKNOWN
 - SWALE ARROW
 - FLOW ARROW

GENERAL NOTES:

1. ALL PROPOSED PAVEMENT RADII TO BE 3' UNLESS OTHERWISE NOTED.
2. ALL STOP SIGNS SHALL REMAIN FROM VISUAL OBSTRUCTIONS.

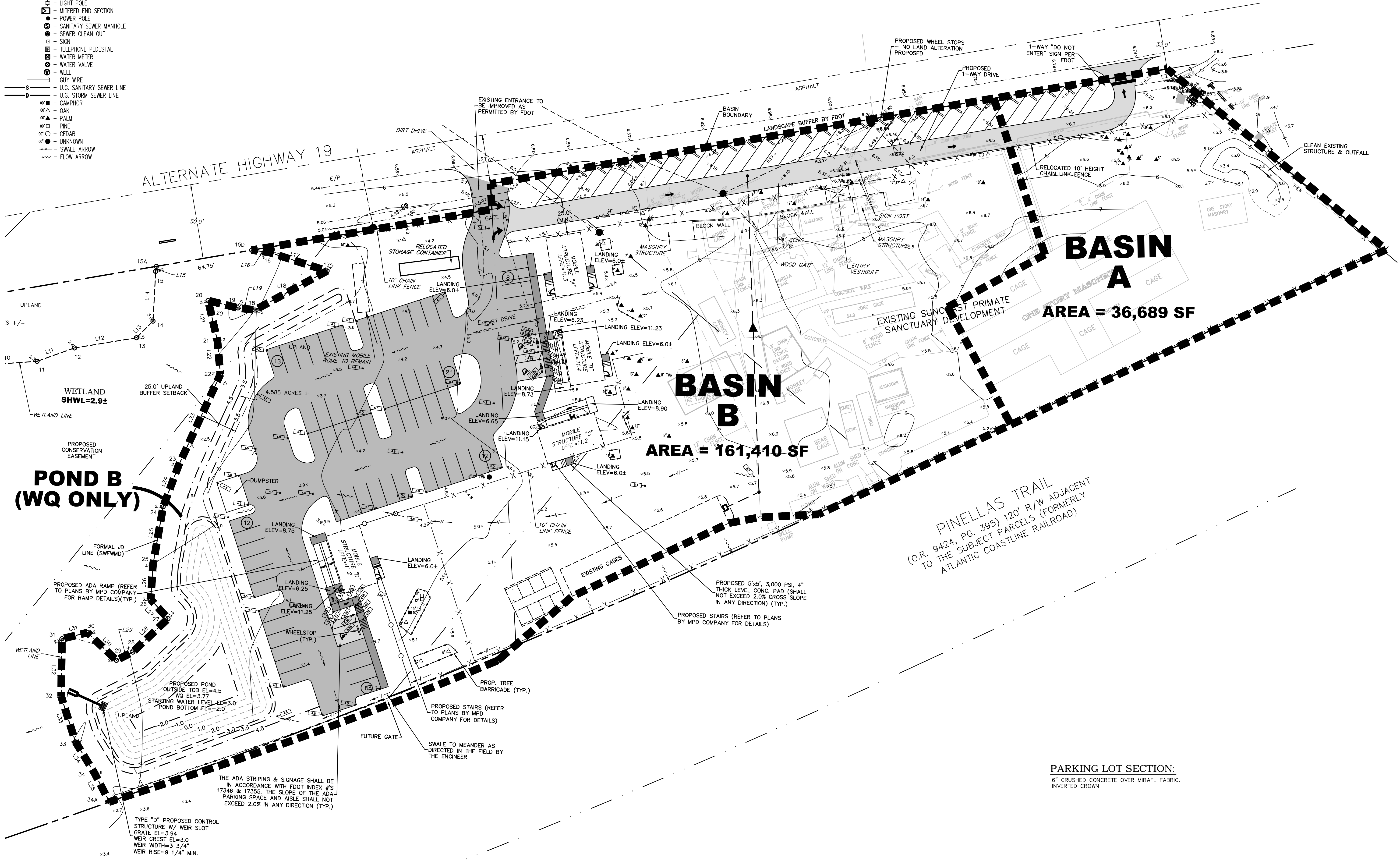
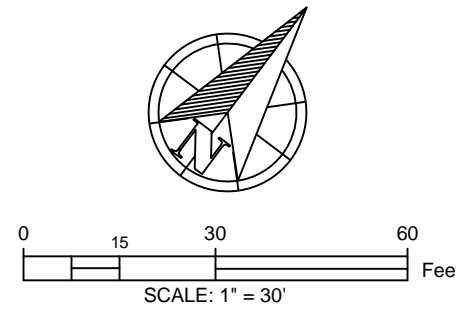

**POND B
(WQ ONLY)**

**BASIN B
AREA = 161,410 SF**

**BASIN A
AREA = 36,689 SF**

PINELLAS TRAIL
(O.R. 9424, PG. 395) 120' R/W ADJACENT
TO THE SUBJECT PARCELS (FORMERLY
ATLANTIC COASTLINE RAILROAD)

THE ADA STRIPING & SIGNAGE SHALL BE
IN ACCORDANCE WITH FDOT INDEX #'S
17346 & 17355. THE SLOPE OF THE ADA
PARKING SPACE AND AISLE SHALL NOT
EXCEED 2.0% IN ANY DIRECTION (TYP.)

TYPE "D" PROPOSED CONTROL
STRUCTURE W/ WEIR SLOT
GRATE EL=3.94
WEIR CREST EL=3.0
WEIR WIDTH=3 3/4"
WEIR RISE=9 1/4" MIN.

PROPOSED 5'x5', 3,000 PSI, 4"
THICK LEVEL CONC. PAD (SHALL
NOT EXCEED 2.0% GROSS SLOPE
IN ANY DIRECTION) (TYP.)

PARKING LOT SECTION:
6" CRUSHED CONCRETE OVER MIRAFI FABRIC,
INVERTED CROWN

NOTICE TO CONTRACTOR/OWNER
CONSTRUCTION IS NOT AUTHORIZED UNTIL PLANS HAVE BEEN ISSUED BY
LANDON, MOREE & ASSOCIATES, INC. STAMPED FOR CONSTRUCTION

Design: JCL Scale: 1"=30'
Drawn: JDC Date: 03-31-2017
Checked: JCL Job No.: 000-152-07

COPYRIGHT 2017
ALL RIGHTS RESERVED
Landon, Moree & Associates, Inc.
4600 ALTERNATE HIGHWAY 19
PALM HARBOR, FLORIDA 34683
DO NOT COPY OR REPRODUCE

**SUNCOAST PRIMATE SANCTUARY
PARKING LOT**

SUNCOAST PRIMATE SANCTUARY
4600 ALTERNATE HIGHWAY 19
PALM HARBOR, FLORIDA 34683

EB #4096

LMA
Landon, Moree & Associates, Inc.
Civil & Environmental Engineers - Planners - Surveyors
31629 U.S. 10 NORTH, PALM HARBOR, FLORIDA 34684
Phone: (272)782-8010 Fax: (272)782-8394
Toll Free: 1-800-242-7960 WWW.LMAENR.COM